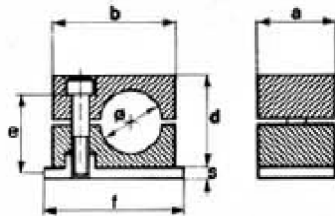
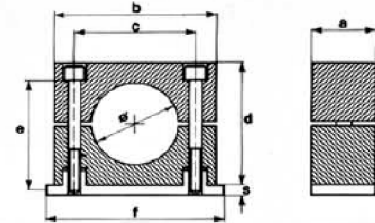

STANDARD CLAMPS

Material : Polypropylene

 gruppo
group **0**

COLLARE STANDARD

Materiale : Polypropylene

 gruppo
group **1÷6**

Part nr. codice	∅ OD		Group Gruppo	a		b		c		d		e
	[in]	[mm]		[in]	[mm]	[in]	[mm]	[in]	[mm]	Gruppo	[in]	
5300300006	0,24	6,0	0	1,18	30,0	1,10	28,0	-	-	1,06	27,0	M6-20
5300300008	0,32	8,0	0	1,18	30,0	1,10	28,0	-	-	1,06	27,0	M6-20
5300300010	0,39	10,0	0	1,18	30,0	1,10	28,0	-	-	1,06	27,0	M6-20
5300300012	0,47	12,0	0	1,18	30,0	1,10	28,0	-	-	1,06	27,0	M6-20
5300310006	0,24	6,0	1	1,18	30,0	1,34	34,0	0,79	20,0	1,06	27,0	M6-20
5300310008	0,32	8,0	1	1,18	30,0	1,34	34,0	0,79	20,0	1,06	27,0	M6-20
5300310010	0,39	10,0	1	1,18	30,0	1,34	34,0	0,79	20,0	1,06	27,0	M6-20
5300310012	0,47	12,0	1	1,18	30,0	1,34	34,0	0,79	20,0	1,06	27,0	M6-20
5300320014	0,55	14,0	2	1,18	30,0	1,58	40,0	1,02	26,0	1,30	33,0	M6-25
5300320015	0,59	15,0	2	1,18	30,0	1,58	40,0	1,02	26,0	1,30	33,0	M6-25
5300320016	0,63	16,0	2	1,18	30,0	1,58	40,0	1,02	26,0	1,30	33,0	M6-25
5300320018	0,71	18,0	2	1,18	30,0	1,58	40,0	1,02	26,0	1,30	33,0	M6-25
5300330020	0,79	20,0	3	1,18	30,0	1,89	48,0	1,30	33,0	1,38	35,0	M6-30
5300330022	0,87	22,0	3	1,18	30,0	1,89	48,0	1,30	33,0	1,38	35,0	M6-30
5300330025	0,99	25,0	3	1,18	30,0	1,89	48,0	1,30	33,0	1,38	35,0	M6-30
5300340028	1,10	28,0	4	1,18	30,0	2,25	57,0	1,58	40,0	1,65	42,0	M6-35
5300340030	1,18	30,0	4	1,18	30,0	2,25	57,0	1,58	40,0	1,65	42,0	M6-35
5300340032	1,26	32,0	4	1,18	30,0	2,25	57,0	1,58	40,0	1,65	42,0	M6-35
5300350035	1,38	35,0	5	1,18	30,0	2,68	68,0	2,05	52,0	2,29	58,0	M6-50
5300350038	1,50	38,0	5	1,18	30,0	2,68	68,0	2,05	52,0	2,29	58,0	M6-50
5300350042	1,65	42,0	5	1,18	30,0	2,68	68,0	2,05	52,0	2,29	58,0	M6-50
5300350045	1,77	45,0	5	1,18	30,0	2,68	68,0	2,05	52,0	2,29	58,0	M6-50
5300360048	1,89	48,0	6	1,18	30,0	3,39	86,0	2,60	66,0	2,60	66,0	M6-60

DOUBLE CLAMPS

Material : Polypropylene

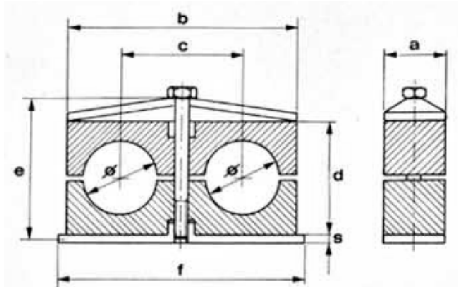
COLLARE DOPPIO

Materiale : Polypropylene

<i>part nr.</i> <i>codice</i>	\varnothing OD [in]	Group [mm]	<i>a</i> Gruppo	<i>b</i> [in]	<i>c</i> [mm]	<i>d</i> [in]	<i>e</i> [mm]	<i>part nr.</i> <i>codice</i>	\varnothing OD [in]	Group [mm]	<i>a</i> Gruppo	<i>b</i> [in]
5300410088	0,32	8,0	1	1,18	30,0	1,46	37,0	0,79	20,0	0,99	25,0	M6-35
5300410012	0,47	12,0	1	1,18	30,0	1,46	37,0	0,79	20,0	0,99	25,0	M6-35
5300420014	0,55	14,0	2	1,18	30,0	2,09	53,0	1,14	29,0	1,02	26,0	M8-35
5300420016	0,63	16,0	2	1,18	30,0	2,09	53,0	1,14	29,0	1,02	26,0	M8-35
5300420018	0,71	18,0	2	1,18	30,0	2,09	53,0	1,14	29,0	1,02	26,0	M8-35
5300420020	0,79	20,0	3	1,18	30,0	2,64	67,0	1,42	36,0	1,46	37,0	M8-45
5300420022	0,87	22,0	3	1,18	30,0	2,64	67,0	1,42	36,0	1,46	37,0	M8-45
5300420028	1,10	28,0	4	1,18	30,0	3,23	82,0	1,77	45,0	1,65	42,0	M8-50
5300420030	1,18	30,0	4	1,18	30,0	3,23	82,0	1,77	45,0	1,65	42,0	M8-50
5300420033	1,33	33,7	5	1,18	30,0	4,18	106,0	2,21	56,0	2,13	54,0	M8-60
5300420035	1,38	35,0	5	1,18	30,0	4,18	106,0	2,21	56,0	2,13	54,0	M8-60